

"Boss"[®]
MINI-CYCLE

PARTS
CATALOG



● A BANGOR PUNTA COMPANY

"Boss" MINI-CYCLE

Parts listed in this catalog are for both the 50cc "Boss" Mini-cycle, with 10 inch wheels, and the 55cc "Boss" Super T.T., with 12 inch wheels. Part numbers ending in -10 are for the 50cc "Boss" Mini-cycle only. Part numbers ending in -12 are for the 55cc "Boss" Super T.T., only. All other parts are for both cycles.

EXAMPLE:

A-027	Gasket clutch side cover	(for both cycles)
A-028-12	Magneto Cover	(55cc Super T.T. only)
A-028-10	Magneto Cover	(50cc Mini-cycle only)

"Boss"®

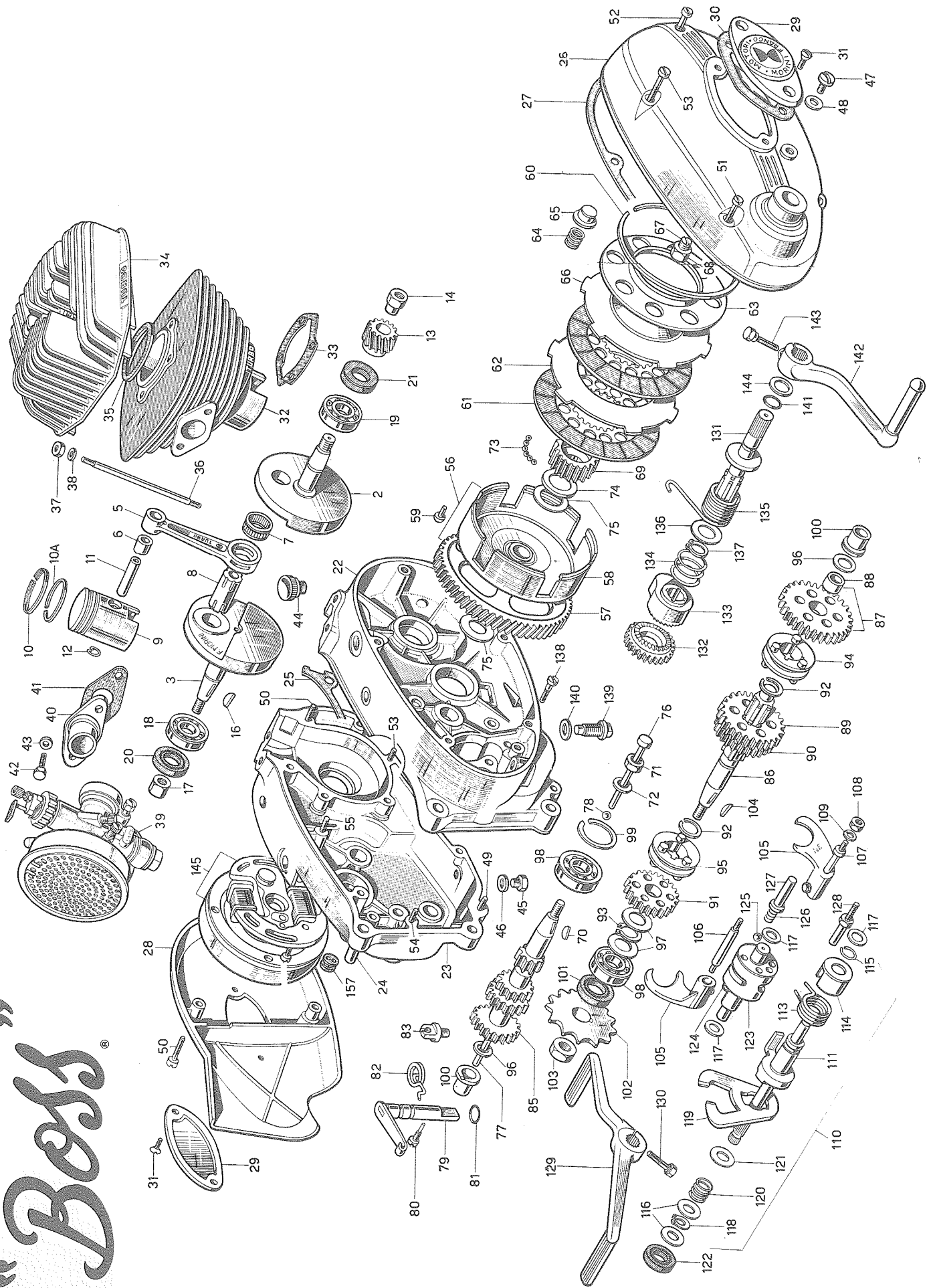

ENGINE

Ref. No.	Part Number	Description	Ref. No.	Part Number	Description	Ref. No.	Part Number	Description
1	A-001	Crankshaft Assembly	34	A-034	Cylinder Head	90	A-090	3rd Gear on the Countershaft
2	A-002	Crank Half Right Side	34	A-034-10	Cylinder Head	91	A-091	4th Gear on the Countershaft
3	A-003	Crank Half Left Side	35	A-035	Head Gasket	92	A-092	Circlip
4	A-004	Connecting Rod Assembly	36	A-036	Cylinder Stud	93	A-093	Snap Ring
5	A-005	Connecting Rod	37	A-037	Nut Cylinder Stud	94	A-094	Slide Dog 1st and 2nd
6	A-006	Wrist Pin Bushing	38	A-038	Washer Cylinder Stud	95	A-095	Slide Dog 3rd and 4th
7	A-007	Crank Pin Bearing	39	A-039	Carburetor	96	A-096	Washer
8	A-008	Crank Pin	40	A-040	Intake Manifold	97	A-097	Washer
9	A-009-12	Piston Assembly 41 mm.	41	A-041	Gasket Intake Manifold	98	A-098	Bearing
9	A-009-A-10	Piston Assembly 39 mm	42	A-042	Bolt Intake Manifold	99	A-099	Retaining Ring
9	A-009-B-10	Piston Standard	43	A-043	Washer Intake	100	A-100	Bronze Bushing
9	A-009-C-10	Piston .020 Oversize	44	A-044	Oil Fill Plug	101	A-101	Seal
9	A-009-D-10	Piston .040 Oversize	45	A-045	Oil Drain Plug	102	A-102	Countershaft Sprocket
9	A-009-E-10	Piston .060 Oversize	46	A-046	Washer Oil Drain Plug	103	A-103	Countershaft Sprocket Nut
9	A-009-F-10	Piston .080 Oversize	47	A-047	Oil Level Screw	104	A-104	Woodruff Key
10	A-010-A-10	Top Ring Standard	48	A-048	Washer Oil Level Screw	105	A-105	Shift Fork
10	A-010-B-10	Top Ring .020 Oversize	49	A-049	Screw Mag Cover	106	A-106	Shift Shift Fork
10	A-010-C-10	Top Ring .040 Oversize	50	A-050	Screw Clutch Case	107	A-107	Shift Fork 1st and 2nd
10	A-010-D-10	Top Ring .060 Oversize	51	A-051	Screw Clutch Case	108	A-108	Nut
10	A-010-E-10	Top Ring .080 Oversize	52	A-052	Screw Clutch Case	109	A-109	Lock Washer
10	A-010-F-10	Bottom Ring Standard	53	A-053	Screw Clutch Case	111	A-111	Selector Shaft
10	A-010-J-10	Bottom Ring .020 Oversize	54	A-054	Screw Center Case	113	A-113	Spring Selector Shaft
10	A-010-K-10	Bottom Ring .040 Oversize	55	A-055	Screw Center Case	114	A-114	Spring Retainer
10	A-010-L-10	Bottom Ring .060 Oversize	56	A-056	Clutch Hub Assembly	115	A-115	Circlip
10	A-010-M-10	Bottom Ring .080 Oversize	60	A-060	Clutch Ring	116	A-116	Washer
11	A-011	Wristpin	61	A-061	Clutch Plate	117	A-117	Washer
12	A-012	Circlip	62	A-062	Clutch Plate Inner	118	A-118	Circlip
13	A-013	Pinion Gear	63	A-063	Clutch Pressure Plate	119	A-119	Selector Pawl
14	A-014	Nut Pinion Gear	64	A-064	Clutch Spring	120	A-120	Spring Selector
16	A-016	Wood Ruff Key	65	A-065	Cup Clutch Spring	121	A-121	Spring Stop
17	A-017	Nut, Flywheel	66	A-066	Clutch Plate Outer	122	A-122	Seal Selector Shaft
18	A-018	Main Bearing Left Side	67	A-067	Screw Clutch Adjustment	123	A-123	Shift Drum
19	A-019	Main Bearing Right Side	68	A-068	Lock Nut	124	A-124	Detent Spring
20	A-020	Crankshaft Seal Left Side	69	A-069	Clutch Hub Inner	125	A-125	Ball Detent
21	A-021	Crankshaft Seal Right Side	70	A-070	Key	126	A-126	Spring Detent
22	A-022	Engine Case Right Side	71	A-071	Lock Nut	127	A-127	Housing Detent
23	A-023	Engine Case Left Side	72	A-072	Washer	128	A-128	Pin Selector Spring
24	A-024	Dowel	73	A-073	Ball Bearing	129	A-129	Shift Lever
25	A-025	Gasket Center Case	74	A-074	Washer	130	A-130	Shift Lever Bolt
26	A-026	Side Cover Clutch Side	75	A-075	O-Ring	131	A-131	Kickstart Shaft
27	A-027	Gasket Clutch Side Cover	76	A-076	Clutch Rod Right	132	A-132	Kickstart Drive Gear
28	A-028-12	Magneto Cover	77	A-077	Clutch Rod Left	133	A-133	Kickstart Ratchet
28	A-028-10	Magneto Cover	78	A-078	Ball Clutch Rod	134	A-134	Kickstart Ratchet Spring
30	A-028-A-10	Washer For Fan	79	A-079	Clutch Arm Assembly	135	A-135	Kickstart Return Spring
31	A-028-B-10	Bolt For Fan	80	A-080	Screw Clutch Arm	136	A-136	Kickstart Spring Washer
32	A-028-C-10	Nylon Washer	81	A-081	O-Ring	137	A-137	Kickstart Circlip
32	A-028-D-10	Fan	82	A-082	Spring	138	A-138	Screw Inner Case
32	A-028-E-10	Grill For Fan	83	A-083	Clutch Cable Guide	139	A-139	Drain Plug Clutch Cover
29	A-029	Inspection Cover	84	A-084	Set Of Transmission Gears	140	A-140	Drain Plug Washer
30	A-030	Gasket Inspection Cover	85	A-085	Mainshaft	141	A-141	Kickstart O-Ring
31	A-031	Screw Inspection Cover	86	A-086	Countershaft	142	A-142	Kickstart Lever
32	A-032-12	Cylinder Assembly	87	A-087	1st Gear With Bushing	143	A-143	Kickstart Lever Bolt
32	A-032-10	Cylinder Assembly	88	A-088	Bushing	144	A-144	Kickstart Shaft Washer
33	A-033	Base Gasket	89	A-089	2nd Gear On the Countershaft	145	A-145	Magneto Assembly

157
158
159
160
161
162
163
164
165
166
167
168
169

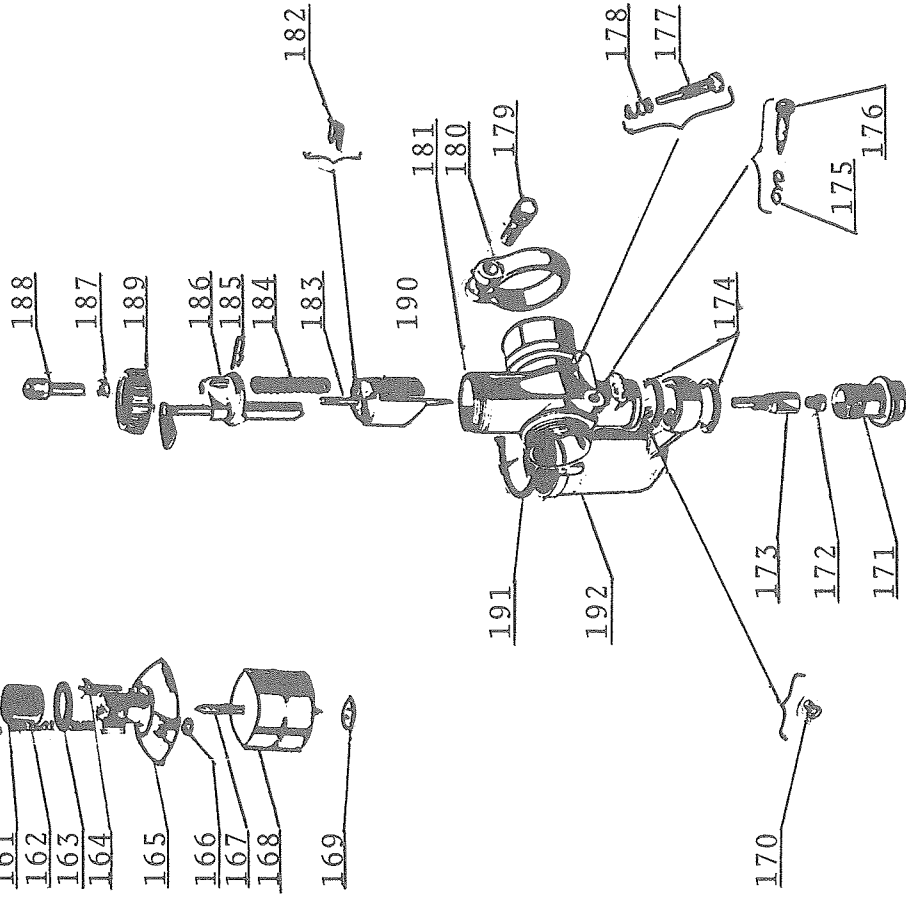
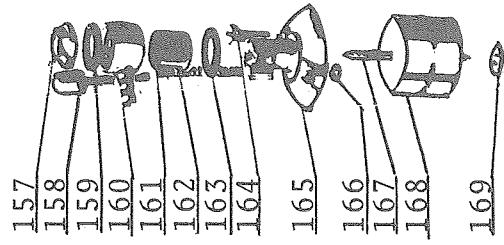

CARBURETOR ASSEMBLY

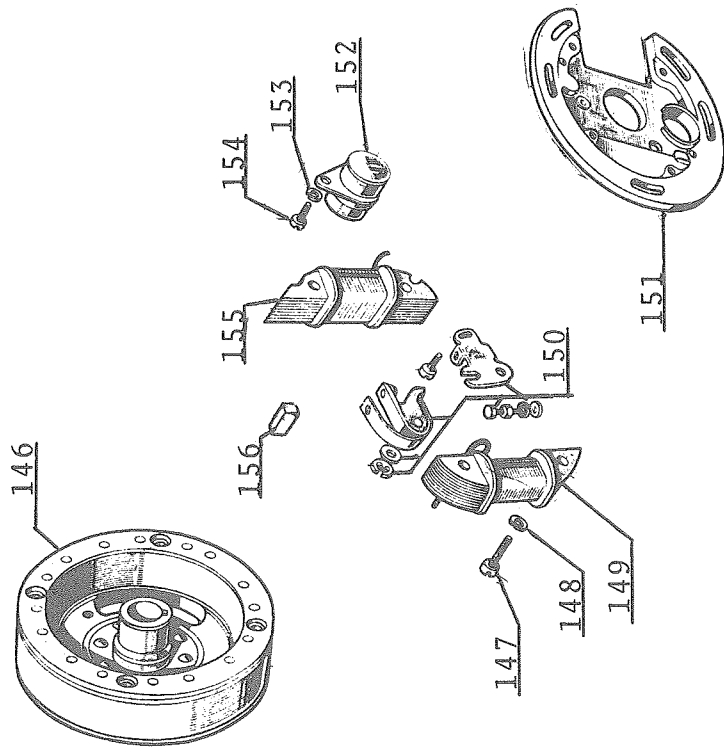

MAGNETO-FLYWHEEL ASSEMBLY

MAGNETO - FLYWHEEL ASSEMBLY

CARBURETOR ASSEMBLY

Ref. No.	Part Number	Description	Ref. No.	Part Number	Description
146	A-140	Magneto Rotor	157	A-157	Nut For Banjo Mounting
147	A-147	Screw Mag Coil	158	A-158	Tickler
148	A-148	Lock Washer	159	A-159	Banjo Gasket
149	A-149	Mag Coil	160	A-160	Banjo
150	A-150	Rotor Points	161	A-161	Fuel Filter
151	A-151	Stator Plate	162	A-162	Tickler Spring
152	A-152	Condenser	163	A-163	Banjo Gasket
153	A-153	Lock Washer	164	A-164	Screw Float Chamber
154	A-154	Screw	165	A-165	Top Carburator
155	A-155	Mag Coil	166	A-166	Tickler Circlip
156	A-156	Felt Oiler	167	A-167	Needle
			168	A-168	Float
			169	A-169	Circlip
			170	A-170	Pilot Jet
			171	A-171	Bolt For Float Chamber
			172	A-172	Main Jet
			173	A-173	Jet Block
			174	A-174	Gasket
			175	A-175	Spring
			176	A-176	Low Speed Adjusting Screw
			177	A-177	Adjusting Screw
			178	A-178	Spring
			179	A-179	Screw Mounting Clamp
			180	A-180	Mounting Clamp
			181	A-181	Carburator Body
			182	A-182	Needle Clip
			183	A-183	Float Needle
			184	A-184	Slide Spring
			185	A-185	Clip
			186	A-186	Carburator Top With Choke
			187	A-187	Nut Throttle Adjustor
			188	A-188	Throttle Adjustor
			189	A-189	Carburator Top
			190	A-190	Slide
			191	A-191	Float Gasket
			192	A-192	Float Chamber

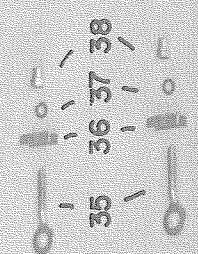
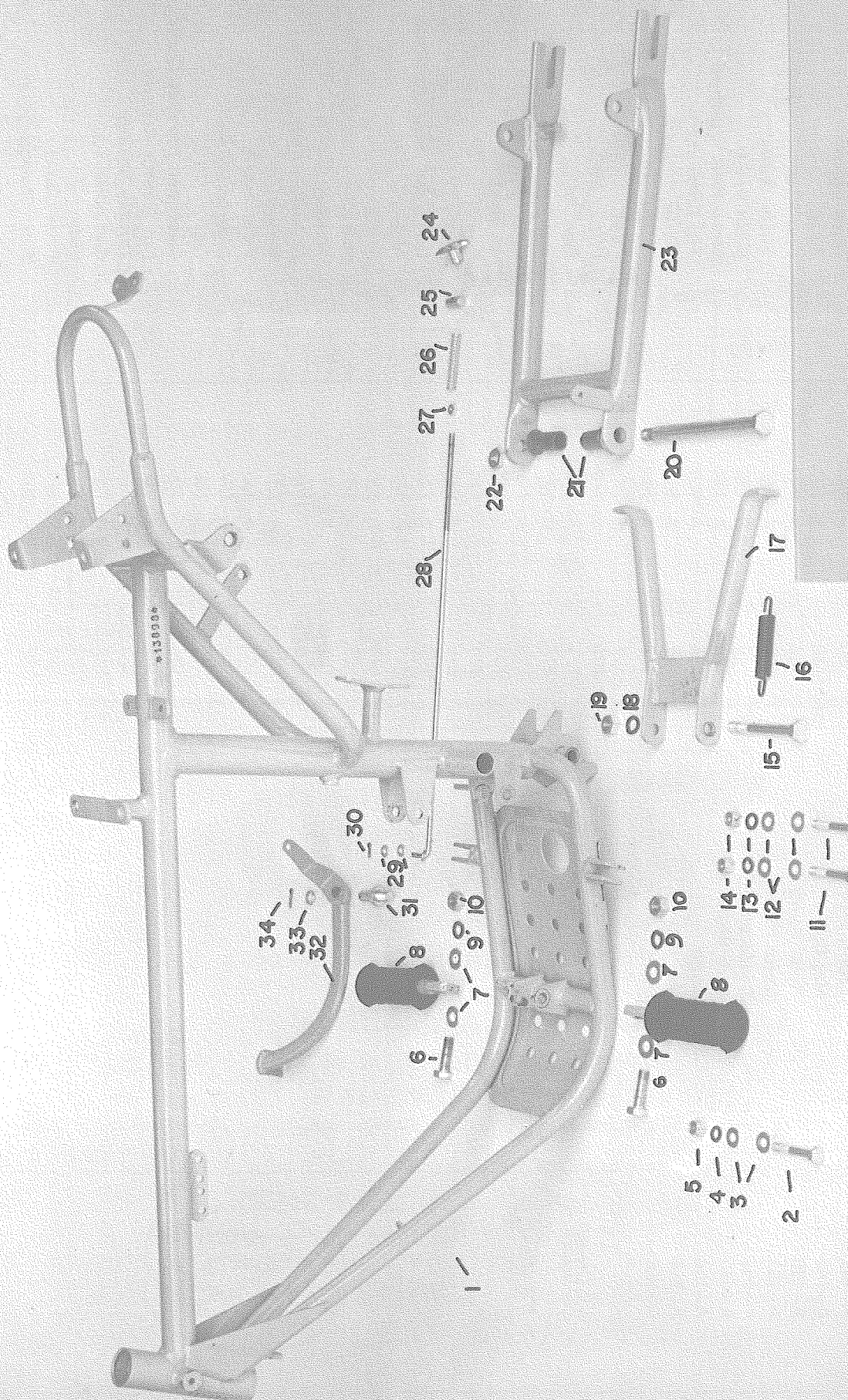

13010

1

FRAME

Ref. No.	Part Number	Description	Ref. No.	Part Number	Description
1	B-001	Frame	31	B-031	Brake Pedal Pivot
2	B-002	Front Engine Mount Bolt	32	B-032	Brake Pedal
3	B-003	Front Engine Mount Washer	33	B-033	Brake Pedal Washer
4	B-004	Front Engine Mount Lock Washer	34	B-034	Brake Pedal Cotter Pin
5	B-005	Front Engine Mount Nut	35	B-035	Chain Adjustor
6	B-006	Foot Peg Bolt	36	B-036	Chain Adjustor End Plate
7	B-007	Foot Peg Washer	37	B-037	Chain Adjustor Lock Washer
8-A	B-008-A	Left Foot Peg	38	B-038	Chain Adjustor Nut
8-B	B-008-B	Right Foot Peg			
9	B-009	Foot Peg Lock Washer			
10	B-010	Foot Peg Nut			
11	B-011	Rear Engine Mount Bolt			
12	B-012	Rear Engine Mount Washer			
13	B-013	Rear Engine Mount Lock Washer			
14	B-014	Rear Engine Mount Nut			
15	B-015	Center Stand Bolt			
16	B-016	Center Stand Spring			
17	B-017-12	Center Stand			
17	B-017-10	Center Stand			
18	B-018	Center Stand Lock Washer			
19	B-019	Center Stand Nut			
20	B-020	Swing Arm Pivot Axle			
21	B-021	Swing Arm Bushing			
22	B-022	Swing Arm Pivot Nut			
23	B-023	Swing Arm			
24	B-024	Brake Rod Adjustor Nut			
25	B-025	Brake Rod Adjustor			
26	B-026	Brake Rod Adjustor Spring			
27	B-027	Brake Rod Washer			
28	B-028	Brake Rod			
29	B-029	Brake Rod Washer			
30	B-030	Brake Rod Cotter Pin			

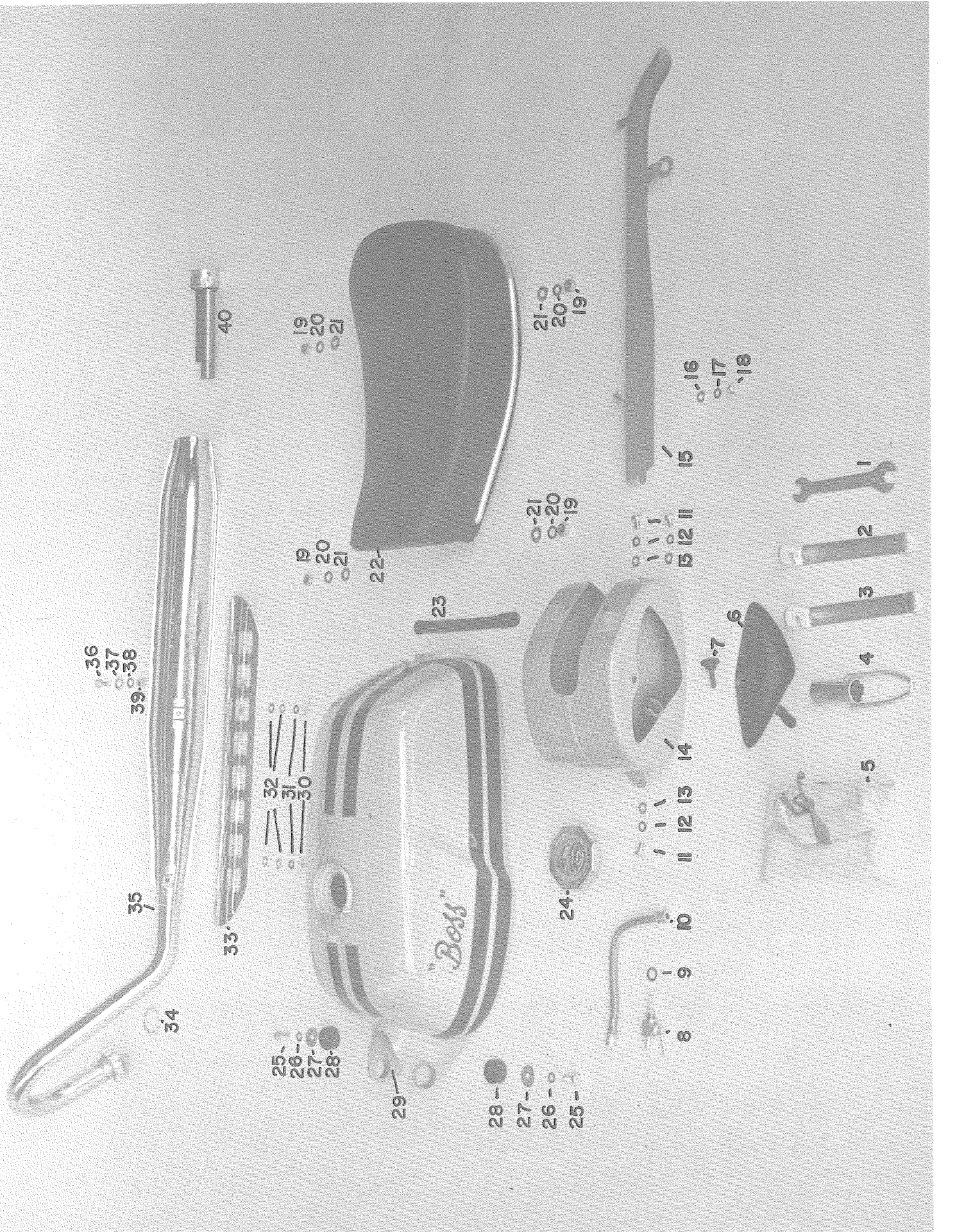

36
37
38
39

34
35

33

32
31
30

25
26
27
28

29

23

19
20
21

22

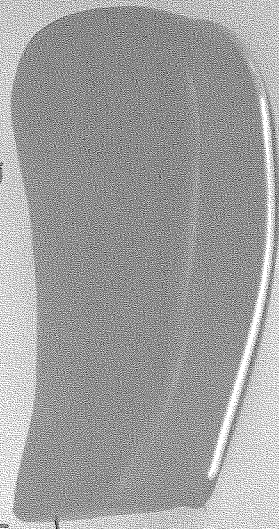

21
20
19

28
27
26
25

21
20
19

24

8
9
10

11
12
13
14

11
12
11
15



16
17
18

15

4
7
6

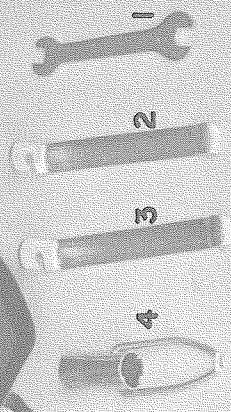

2

3

4

5

40

Ref. No.	Part Number	Description	Ref. No.	Part Number	Description
1	C-001	Wrench	33	C-033	Heat Shield
2	C-002	Tire Iron	34	C-034	Exhaust Gasket
3	C-003	Tire Iron	35	C-035	Exhaust Pipe and Muffler
4	C-004	Spark Plug Tool	36	C-036	Exhaust Pipe Mounting Bolt
5	C-005	Tool Bag	37	C-037	Exhaust Pipe Mounting Washer
6	C-006	Tool Kit Cover	38	C-038	Exhaust Pipe Mounting Lock Washer
7	C-007	Tool Kit Cover Knob	39	C-039	Exhaust Pipe Mounting Nut
8	C-008	Petcock	40	C-040	Resonator
9	C-009	Petcock Washer			
10	C-010	Fuel Line			
11	C-011	Tool Kit Bolt			
12	C-012	Tool Kit Lock Washer			
13	C-013	Tool Kit Washer			
14	C-014	Tool Kit			
15	C-015	Chain Guard			
16	C-016	Chain Guard Washer			
17	C-017	Chain Guard Lock Washer			
18	C-018	Chain Guard Bolt			
19	C-019	Seat Mount Nut			
20	C-020	Seat Mount Lock Washer			
21	C-021	Seat Mount Washer			
22	C-022	Seat			
23	C-023	Tank Hold Down			
24	C-024	Gas Cap			
25	C-025	Fuel Tank Mounting Bolt			
26	C-026	Fuel Tank Lock Washer			
27	C-027	Fuel Tank Washer			
28	C-028	Fuel Tank Rubber Spacer			
29	C-029	Fuel Tank			
30	C-030	Heat Shield Bolt			
31	C-031	Heat Shield Lock Washer			
32	C-032	Heat Shield Washer			

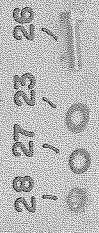
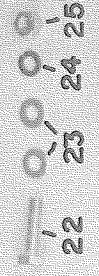
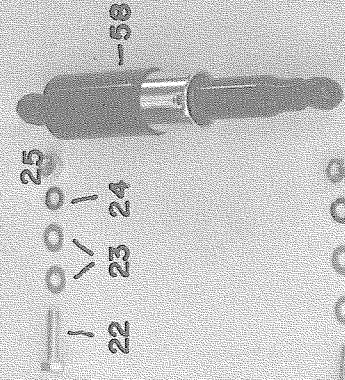
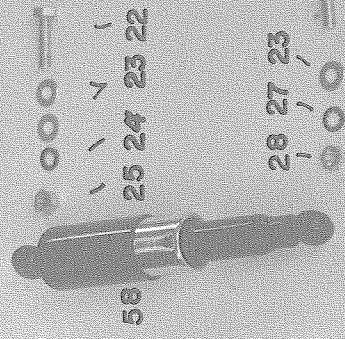
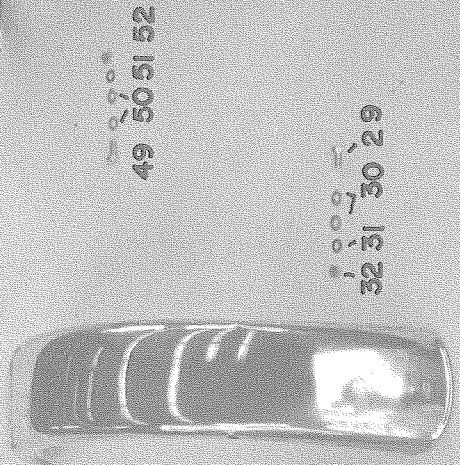
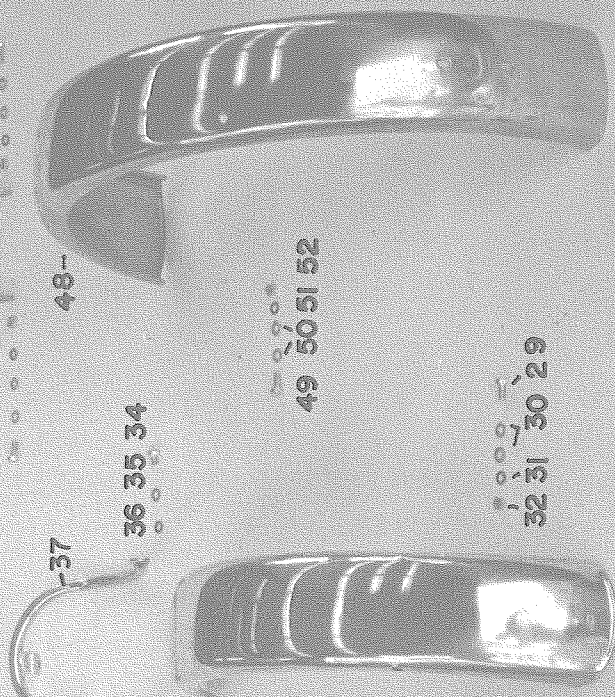
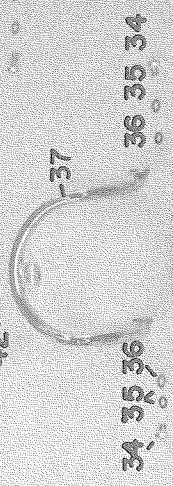
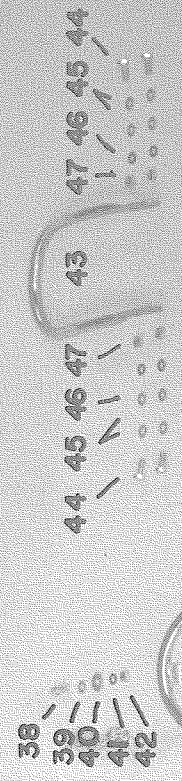
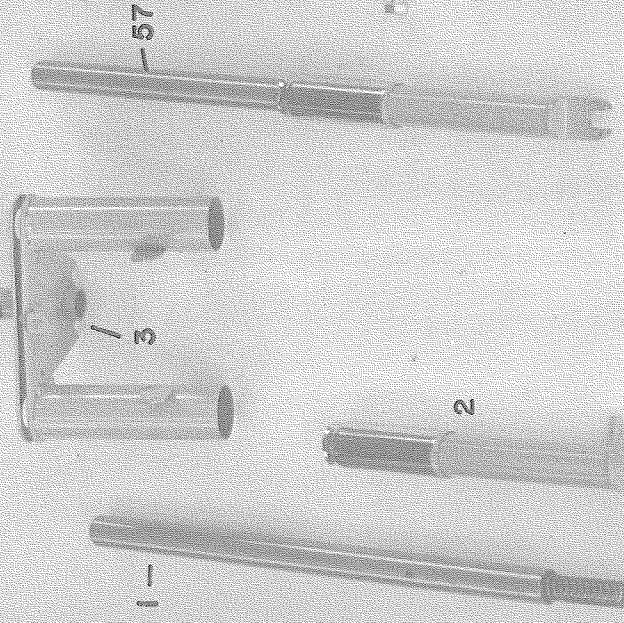
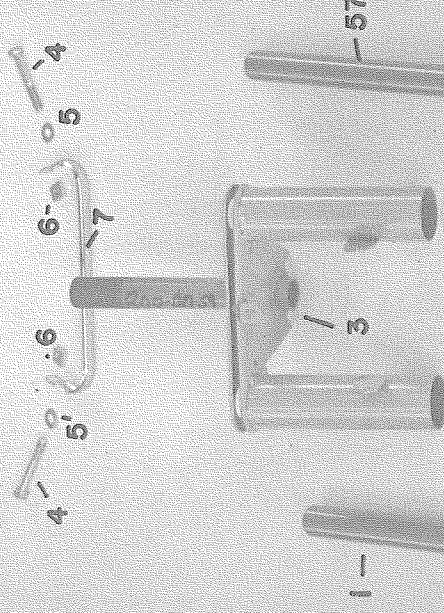
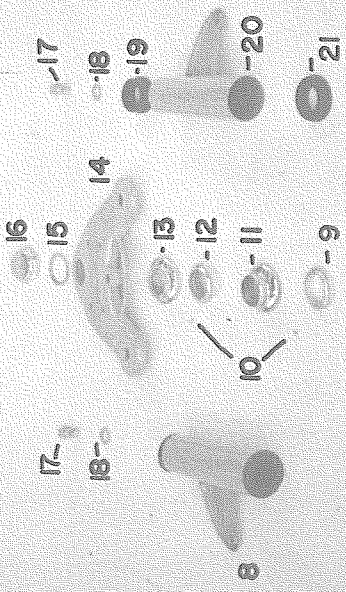

SUSPENSION AND FENDERS

Ref. No.	Part Number	Description	Ref. No.	Part Number	Description
1	D-001	Fork Tube With Spring	35	D-035	Front Fender Mounting Lock Washer
2-A	D-002-A	Lower Fork Leg, Right	36	D-036	Front Fender Mounting Washer
2-B	D-002-B	Lower Fork Leg, Left	37	D-037	Front Fender Bracket
3	D-003	Lower Fork Yoke and Stem	38	D-038	Front Fender Mounting Bolt
4	D-004	Pinch Bolt	39	D-039	Front Fender Mounting Washer
5	D-005	Pinch Bolt Washer	40	D-040	Front Fender Mounting Washer
6	D-006	Pinch Bolt Nut	41	D-041	Front Fender Mounting Lock Washer
7	D-007	Lower Fork Yoke Chrome Strip	42	D-042	Front Fender Mounting Nut
8	D-008	Headlight Bracket, Right	43	D-043	Rear Lift Handle
9	D-009	Lower Bearing Race, Inner	44	D-044	Lift Handle Mounting Bolt
10	D-010	Ball Bearing	45	D-045	Lift Handle Mounting Washer
11	D-011	Lower Bearing Race, Outer	46	D-046	Lift Handle Mounting Lock Washer
12	D-012	Upper Bearing Race, Inner	47	D-047	Lift Handle Mounting Nut
13	D-013	Upper Bearing Race, Outer	48	D-048-12	Rear Fender
14	D-014	Upper Fork Yoke	48	D-048-10	Rear Fender
15	D-015	Fork Stem Washer	49	D-049	Rear Fender Mounting Bolt
16	D-016	Steering Stem Nut	50	D-050	Rear Fender Mounting Washer
17	D-017	Bolt	51	D-051	Rear Fender Mounting Lock Washer
18	D-018	Washer	52	D-052	Rear Fender Mounting Nut
19	D-019	Rubber Spacer, Headlight Bracket	53	D-053	Rear Fender Mounting Nut
20	D-020	Headlight Bracket, Left	54	D-054	Rear Fender Mounting Lock Washer
21	D-021	Rubber Spacer, Headlight Bracket	55	D-055	Rear Fender Mounting Washer
22	D-022	Shock Mounting Bolt, Top	56	D-056	Rear Fender Mounting Bolt
23	D-023	Shock Mounting Washer	57-A	D-057-A	Fork Leg Assembly, Right
24	D-024	Shock Mounting Lock Washer	57-B	D-057-B	Fork Leg Assembly, Left
25	D-025	Shock Mounting Nut	58	D-058	Rear Shock Absorber
26	D-026	Shock Mounting Bolt, Bottom			
27	D-027	Shock Mounting Star Washer			
28	D-028	Shock Mounting Nut			
29	D-029	Front Fender Mounting Bolt			
30	D-030	Front Fender Mounting Washer			
31	D-031	Front Fender Mounting Lock Washer			
32	D-032-12	Front Fender Mounting Nut			
33	D-033-10	Front Fender			
34	D-034	Front Fender Mounting Bolt			

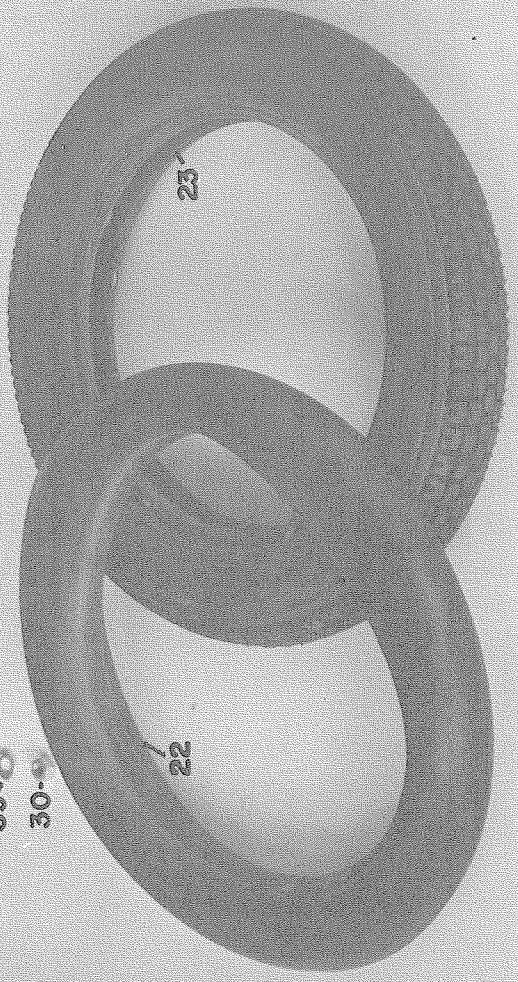
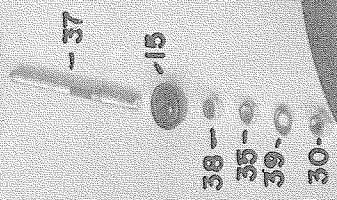
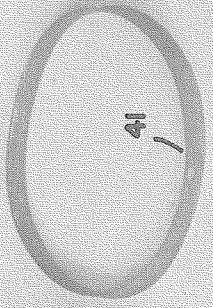
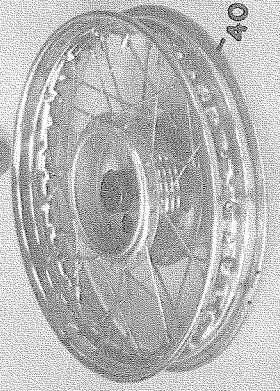
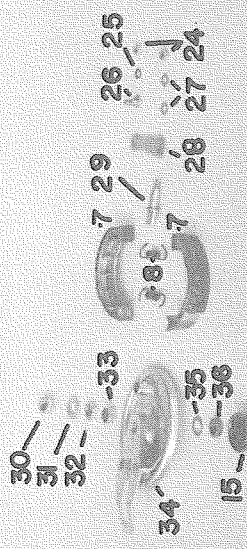
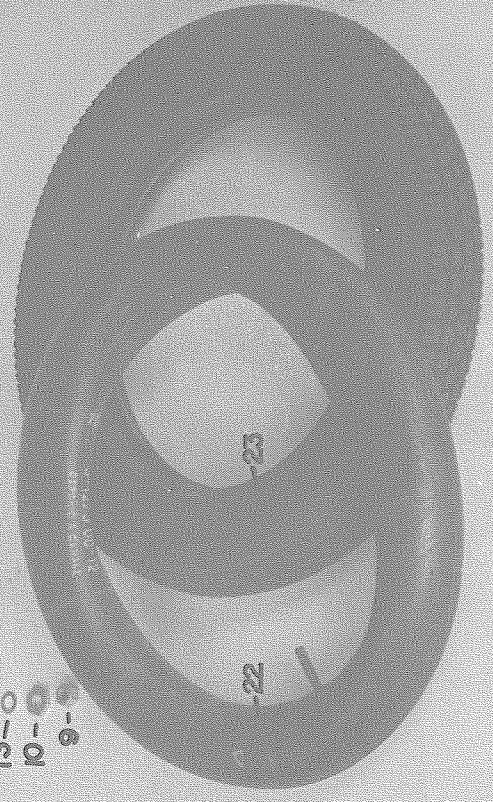
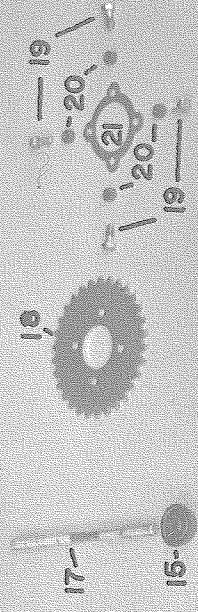
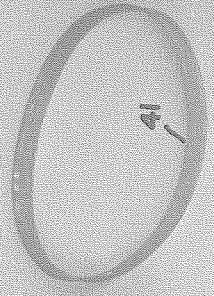
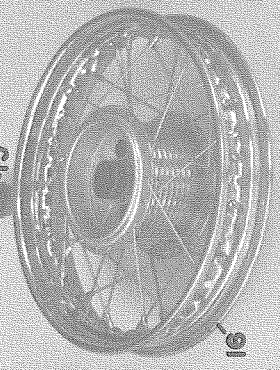
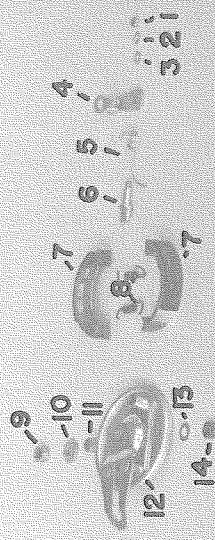

WHEELS

Ref. No.	Part Number	Description	Ref. No.	Part Number	Description
1	E-001	Nut	31	E-031	Washer
2	E-002	Washer	32	E-032	Nut
3	E-003	Washer	33	E-033	Nut
4	E-004	Rear Brake Arm	34	E-034-12	Front Backing Plate
5	E-005	Rear Brake Arm Spring	34	E-034-10	Front Backing Plate
6	E-006	Rear Brake Actuating Cam	35	E-035	Washer
7	E-007-12	Brake Shoe	36	E-036	Nut
7	E-007-10	Brake Shoe	37	E-037	Front Axle
8	E-008-12	Brake Spring	38	E-038	Front Axle Spacer
8	E-008-10	Brake Spring	39	E-039	Washer
9	E-009	Rear Axle Nut	40	E-040-12	Front Wheel
10	E-010	Nut	40	E-040-10	Front Wheel
11	E-011	Nut	41	E-041-12	Rim Band
12	E-012	Rear Backing Plate	41	E-041-10	Rim Band
13	E-013	Washer		E-042-12	Spoke 12" whl
14	E-014	Spacer		E-042-10	Spoke 10" whl
15	E-015	Bearing Races & Bearing		E-043	Nipple
16	E-016-12	Rear Wheel		E-044-12	Rim 12" whl
16	E-016-10	Rear Wheel		E-044-10	Rim 10" whl
17	E-017	Rear Axle			
18	E-018	Rear Sprocket			
19	E-019	Rear Sprocket Bolt			
20	E-020	Rear Sprocket Nut			
21	E-021	Rear Sprocket Lock Washer			
22	E-022-12	3.00 x 12 Tube			
22	E-022-10	3.00 x 10 Tube			
23	E-023-12	3.00 x 12 Tire			
23	E-023-10	3.00 x 10 Tire			
24	E-024	Nut			
25	E-025	Lock Washer			
26	E-026	Bolt			
27	E-027	Washer			
28	E-028	Front Brake Arm			
29	E-029	Front Brake Actuating Cam			
30	E-030	Front Axle Nut			

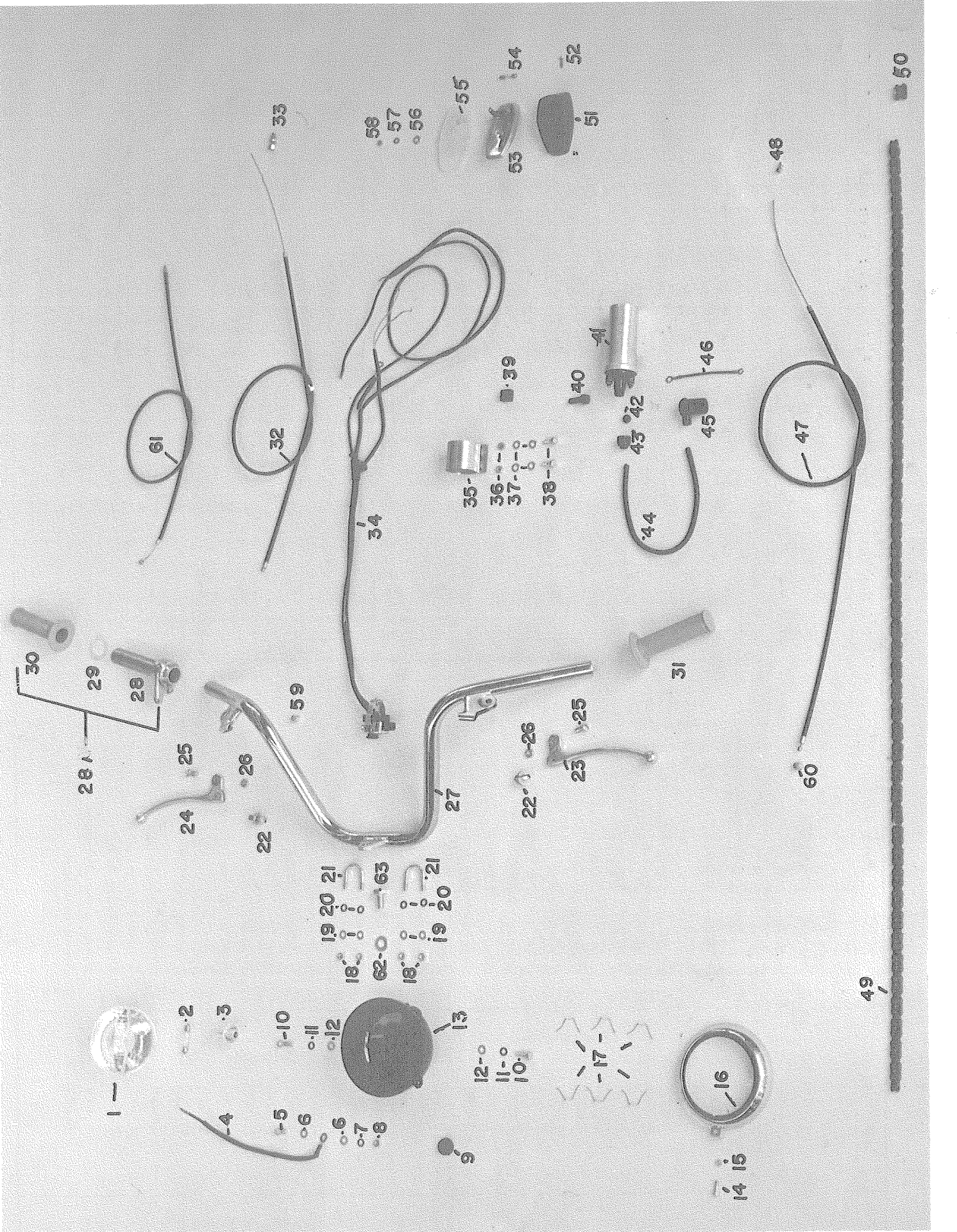

LIGHTING AND CONTROLS

Ref. No.	Part Number	Description	Ref. No.	Part Number	Description
1	F-001	Headlight Lens And Reflector	36	F-036	Coil Bracket Nut
2	F-002	Low Beam Bulb	37	F-037	Coil Bracket Washer
3	F-003	High Beam Bulb	38	F-038	Coil Bracket Bolt
4	F-004	Ground Wire	39	F-039	Junction Block
5	F-005	Ground Wire Bolt	40	F-040	Cable Protector
6	F-006	Ground Wire Washer	41	F-041	Coil
7	F-007	Ground Wire Lock Washer	42	F-042	Rubber Grommet For Coil
8	F-008	Ground Wire Nut	43	F-043	Coil Nut
9	F-009	Rubber Grommet	44	F-044	Coil Wire
10	F-010	Headlight Bolt	45	F-045	Sparky
11	F-011	Headlight Lock Washer	46	F-046	Ground Wire
12	F-012	Headlight Washer	47	F-047	Clutch Cable
13	F-013	Headlight Shell	48	F-048	Clutch Cable End
14	F-014	Headlight Rim Screw	49	F-049	Chain
15	F-015	Headlight Rim Washer	50	F-050	Master Link
16	F-016	Headlight Rim	51	F-051	Tail Light Lens
17	F-017	Lens Retaining Clip	52	F-052	Tail Light Lens Screw
18	F-018	Nut For Handlebar U-Bolt	53	F-053	Tail Light Base
19	F-019	Lock Washer For Handlebar U-Bolt	54	F-054	Tail Light Bulb
20	F-020	Washer For Handlebar U-Bolt	55	F-055	Tail Light Spacer
21	F-021	Handlebar U-Bolt	56	F-056	Tail Light Washer
22	F-022	Cable Adjustor	57	F-057	Tail Light Lock Washer
23	F-023	Clutch Lever	58	F-058	Tail Light Nut
24	F-024	Brake Lever	59	F-059	Front Brake Cable Barrel
25	F-025	Hand Lever Pivot Bolt	60	F-060	Tail Light Complete
26	F-026	Hand Lever Pivot Nut	61	F-061	Throttle Cable
27	F-027	Handlebar	62	F-062	Handlebar Mounting Washer
28	F-028	Throttle Assembly	63	F-063	Handlebar Mounting Bolt
29	F-029	Nylon Spacer			
30	F-030	Throttle Hand Grip			
31	F-031	Dummy Hand Grip			
32	F-032	Front Brake Cable			
33	F-033	Front Brake Cable Adjustor			
34	F-034	Wiring Harness With Switch			
35	F-035	Coil Bracket			

SPECIAL TOOLS

Ref. No.	Part Number	Description
1	G-001	Main Shaft Puller
2	G-002	Sprocket-Chain Fastening Wrench
3	G-003	Magneto-Flywheel Puller
4	G-004	Friction Drum Puller
5	G-006	Magneto-Flywheel Holding Wrench
6	G-007	Clutch Wrench
7	G-008	Clutch Plate Mounting Clamp

